

# Important Information

## HSM V-Press 504 eco

Vertical baling press

Model: HSM V-Press 504 eco

Double door with bell-crank lever  
incl. operating manual / declaration of conformity

- Compact and sturdy design
- Small footprint
- Modern microprocessor controller with membrane keypad and text display
- Selectable programmes for pressing cardboard or plastic foil
- Bale removal and transport with discharge trolley
- Optionally available with mechanical bale ejector
- HSM TCS (TorsionControlSystem) for monitoring press ram movement
- Automatic return stroke
- Basic equipment: 2 rolls of polyester tape



Pressing power in kN	40
Motor in kW	1.1
Voltage / Frequency	1 x 230 V / 50 Hz
Loading aperture W x H in mm	700 x 470
Bale weight in kg (depending on material)	up to 60
Bale size L x W x H in mm	700 x 500 x max. 600
Hourly output in bales	3-6
Cycle time in idle operation (theor.) in sec.	27
Acoustic level in dB(A)	64.3
Press chamber size W x D x H in mm	700 x 500 x 1020
Dimensions of machine* W x D x H in mm	888 x 787 x 1922
Transport dimensions of machine W x D x H in mm	888 x 787 x 1922
Machine weight in kg	290
Strapping	2-fold with polyester tape

\*External dimensions of the machine when set up for operation.

# Dimensions and space requirement HSM V-Press 504 eco

Ceiling height min. 2000 mm

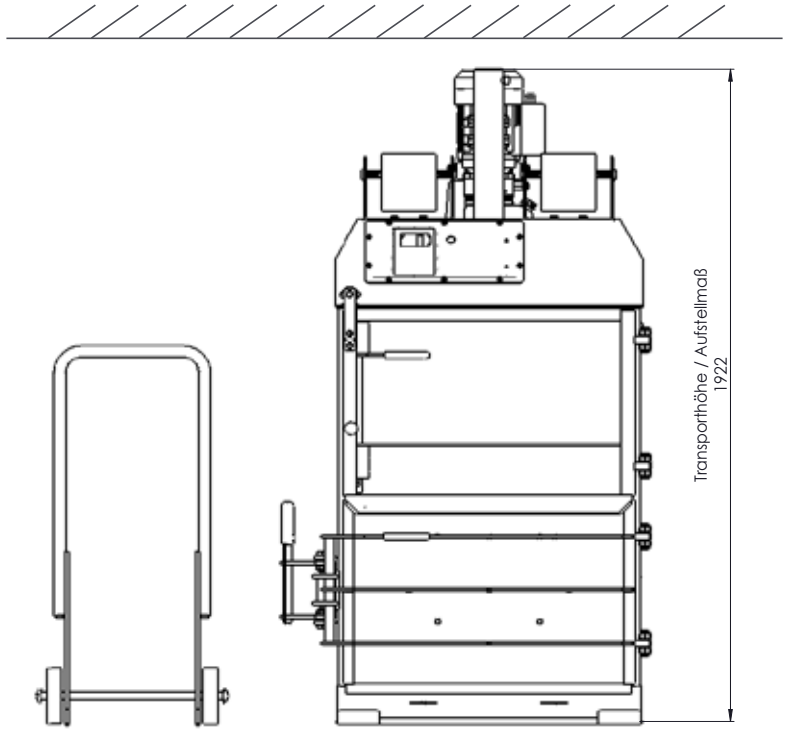

Please note the projections!

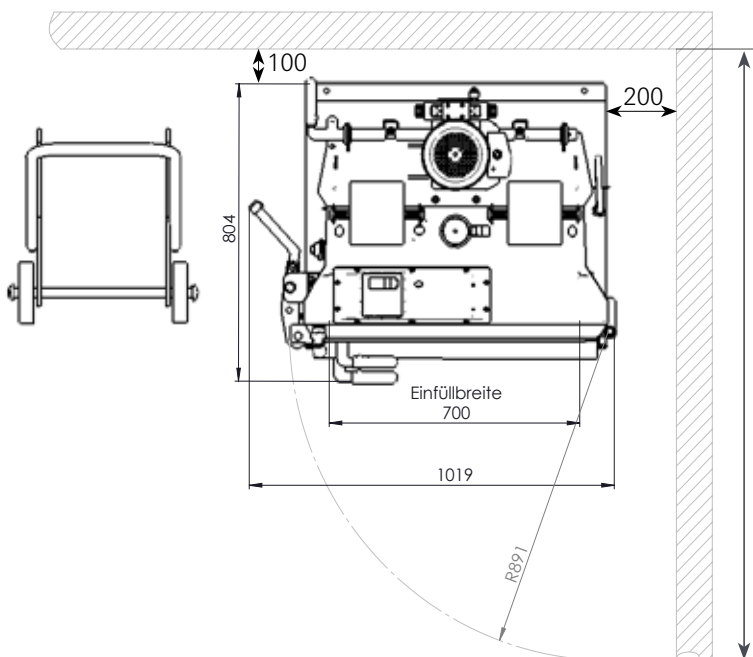

Required entire depth incl. swing  
range of the pressing door: 1825 mm

# Delivery and installation

## HSM V-Press 504 eco

### Delivery by truck:

- Is the place of delivery easily to access?  
If NO – why not?  
\_\_\_\_\_  yes  no
- Do you have to cross a pedestrian zone for the delivery?  yes  no
- Has the truck to go through a gate for the delivery?  
(Dimensions of the gate: \_\_\_\_\_)  yes  no
- Is there a truck loading ramp? (Height: \_\_\_\_\_)  yes  no
- Is a truck with an liftgate needed?  yes  no
- Is there a forklift truck available? (Lifting power: \_\_\_\_\_)  yes  no
- Is there a need to deliver without a trailer?  yes  no
- Are there limited delivery hours?  yes  no

### Movement to the place of installation:

Is there a stair / a higher ledge on the way to the place of installation?  
(an at-grade insertion has to be ensured)

yes  no

Has the press to be transported with an elevator / a lift?  
(loading capacity min. 400 kg)

yes  no

Are the dimensions of the doors high enough for the movement of the machine? (dimensions as pictured)

yes  no

If not: width: \_\_\_\_\_ height: \_\_\_\_\_

Is the potential floor loading adequate for the machine?  
(floor loading max. = 200 kg per m<sup>2</sup>, bale weight enclosed)

yes  no

Is the place of installation with basement?

yes  no

Is there a ceiling height of in minimum 2 m?

yes  no



Floor loading max. = 200 kg per m<sup>2</sup>  
(bale weight enclosed)

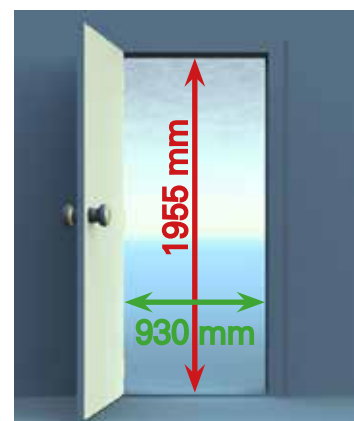

Minimum sizes of the doors / passages

# HSM®

Great Products, Great People.

## Electrical connection HSM V-Press 504 eco

Rated power	1.1 kW
Operating voltage U	230 V
Frequency	50 Hz
Rated current I <sub>n</sub>	2.6 A
Length of power supply	approx. 3000 mm
Power plug	Shockproof plug rubber cover



Is there an electrical connection with the mentioned values at the place of installation?

yes  no

## Consumable materials HSM V-Press 504 eco



### Strapping tape WG 30

Order number: 6205 993 010

## Do you have any questions?

You can reach us on Phone: +971 4885 4249, Fax: +971 4885 1102,  
Email: [sales@germandistribution.com](mailto:sales@germandistribution.com)

Contact person: \_\_\_\_\_

Telephone: \_\_\_\_\_

Delivery address: \_\_\_\_\_  
\_\_\_\_\_

Place / Date / Customer signature:  
  
\_\_\_\_\_